

Internal door mount

# HEX050PA series

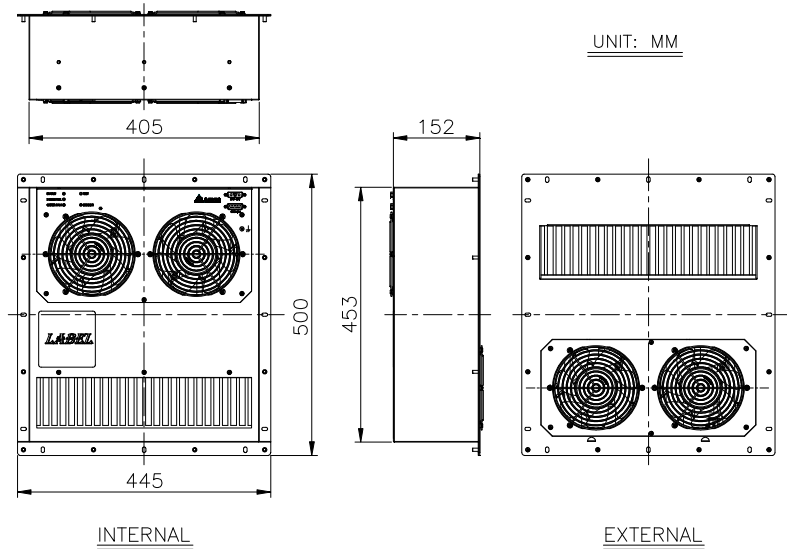

Dimension drawing



Features

- ◆ IP55 waterproof at external side
- ◆ "One touch" dry run test and dust cleaning
- ◆ Standalone temperature control
- ◆ Clear LED status indicator
- ◆ Dry contact alarm output

Design

- ◆ Air to air heat exchange
- ◆ Rated voltage at 48V
- ◆ Redundant fan quantity design
- ◆ High efficiency and reliable fan
- ◆ Easy installation and maintenance

Main feature	Unit	Specification
Dimension (H x W x D)	mm (inch)	500 x 445 x 152 (20 x 18 x 6)
Cooling capacity* <sub>Note</sub>	W/K (W/°F)	45 (25)
Rated voltage	VDC	48
Operating current	A	1.2
Operating power	W	58
Operating voltage range	VDC	40 ~ 60
Operating temperature range	°C	-10 ~ +65
Noise (1.5 meter)	dB-A	65.0
Weight	Kg (Lb)	10 (22)

\* Note : The cooling capacity (W/K , W/°C or W/°F) is defined as  $Q / (T_I - T_A)$

Q : Heat dissipation (W) from inside of cabinet

T<sub>I</sub> : Return temperature of internal air circuit (K , °C or °F)

T<sub>A</sub> : Ambient temperature of external air circuit (K , °C or °F)

\* Specifications are subject to change without notice.